



# Pioneer DJ DDJ-SX3 Quick-Start Guide

# Setup

## Serato Software

The Pioneer DJ DDJ-SX3 is a “Serato DJ Pro hardware unlocked” device, meaning it works with Serato DJ Pro out of the box.

**Please ensure you have the latest version of Serato DJ Pro installed:**

[Click here to download Serato DJ Pro](#)

## Driver Software

The Pioneer DJ DDJ-SX3 requires manufacturer specific drivers on both Mac & Windows operating systems. Connect the device to your computer, open Serato DJ Pro - and when prompted, click “Install Driver”. Alternatively, visit Pioneer’s website and download and install drivers separately, [here](#).

## Overview

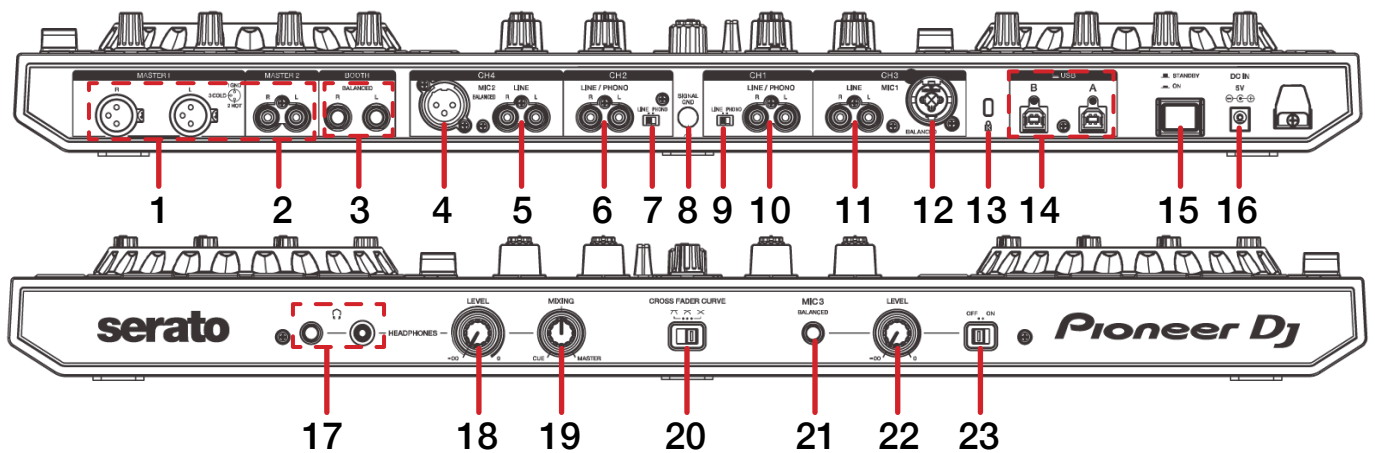

#	PIONEER DJ DDJ-SX3 CONTROL	FUNCTION
1	MASTER 1	XLR Master output
2	MASTER 2	RCA Master output
3	BOOTH	Booth 1/4" output
4	MIC2 IN	XLR microphone input
5	CH4 LINE IN	Channel 4 RCA input
6	CH2 LINE/PHONO	Channel 2 RCA input
7	LINE/PHONO SWITCH	Toggle LINE/PHONO for CH2
8	GROUNDING POST	Connect grounding wire
9	LINE/PHONO SWITCH	Toggle LINE/PHONO for CH1
10	CH1 LINE/PHONO	Channel 1 RCA input
11	CH3 LINE	Channel 3 RCA input
12	MIC1 IN	XLR & 1/4" microphone input

#	PIONEER DJ DDJ-SX3 CONTROL	FUNCTION
13	KENSINGTON LOCK	Connect Kensington Lock
14	USB A / B	Connect USB cable from PC to USB A / USB B
15	POWER SWITCH	Turn device on
16	DC IN	DC power input
17	HEADPHONE OUT	1/8" & 1/4" headphone output
18	HEADPHONE LEVEL	Adjust headphone gain
19	HEADPHONE MIX	Adjust headphone mix between CUE and MASTER
20	CROSS FADER CURVE	Adjust crossfader curve
21	MIC3 IN	1/4" microphone input
22	MIC LEVEL ADJUST	Adjust microphone input gain
23	MIC ON/OFF	Turn microphone on or off

# Overview

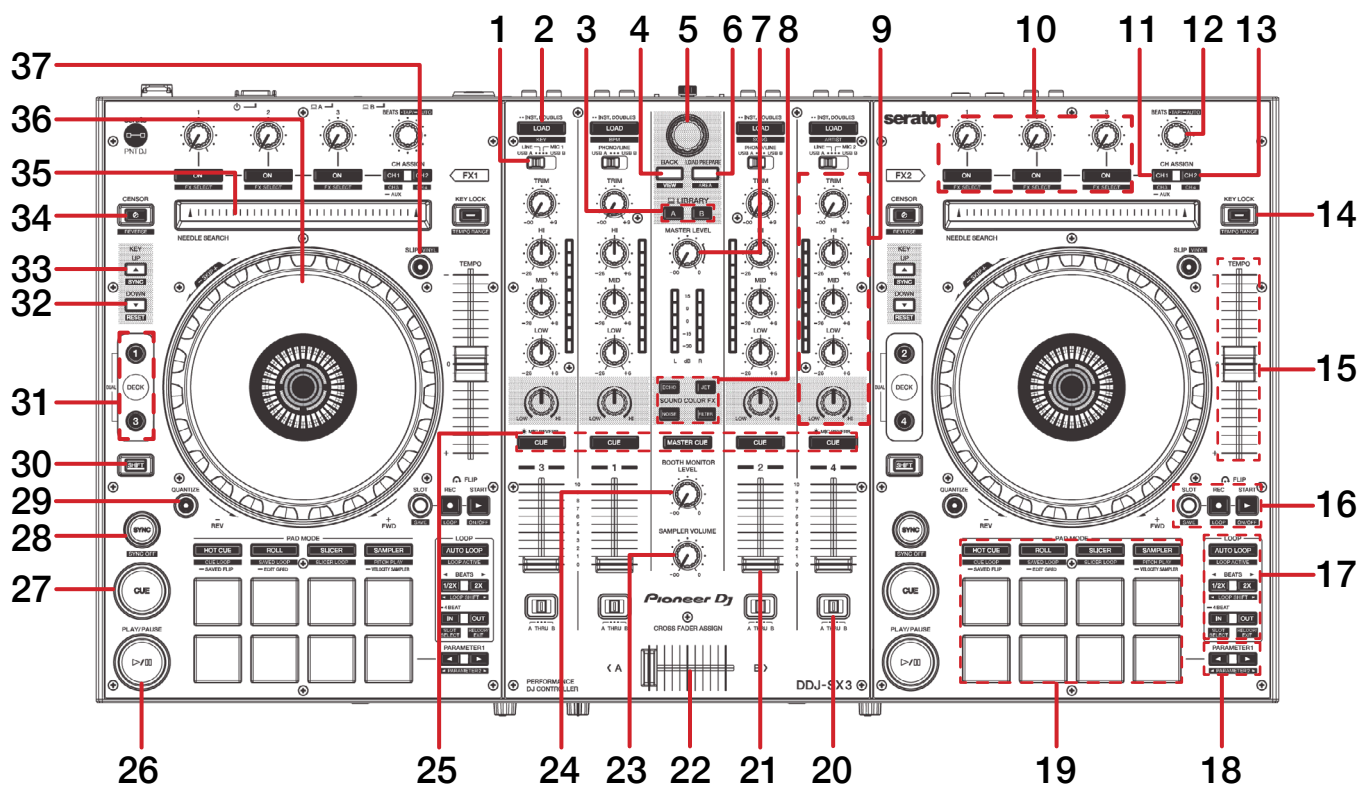

#	PIONEER DJ DDJ-SX3 CONTROL	FUNCTION	SHIFT FUNCTION
1	SOURCE/INPUT SELECT	Toggle between sources per deck	
2	LOAD	Load selected track to deck. Press twice to instant double	Sort library by KEY/BPM/SONG/ARTIST (per channel)
3	USB SOURCE SELECT	Toggle between USB A or USB B	Ignore Tempo / Pitch adjustment
4	BACK	Toggle focus back between Library and Crate list	Toggle Serato DJ Pro view modes
5	BROWSE	Library Scroll. Press to toggle between track and crate selection.	Fast library scroll. Press in for Library back
6	LOAD PREPARE	Loads the highlighted track to Prepare Crate	Toggle through Serato DJ Pro areas
7	MASTER LEVEL	Adjust Master output level	
8	COLOR FX	Hardware specified Pioneer Color FX. Refer to Pioneer use guide for more information	
9	CHANNEL GAIN/EQ/FILTER	Channel gain, EQ, and Filter controls	
10	FX SECTION	Control FX <a href="#">SEE DJ-FX FOR MORE INFORMATION</a>	
11	FX CHANNEL 1 ASSIGN	Press to assign FX section for channel 1	Press to enable FX section assign for channel 3
12	BEATS ENCODER	Turn to adjust FX Beats multiplier	Tap to manually approximate FX BPM, long press to change back to auto
13	FX CHANNEL 2 ASSIGN	Press to assign FX section for channel 2	Press to assign FX section per channel 4
14	KEY LOCK	Toggle Keylock	Cycle Temp Range
15	TEMPO SLIDER	Adjust temp/pitch	Ignore adjustment (if sync is enabled)
16	FLIP CONTROLS	Flip controls <a href="#">SEE FLIP FOR MORE INFORMATION</a>	
17	LOOP CONTROLS	Engage autoloop, and 1/2x or 2x loop length <a href="#">SEE LOOPING FOR MORE INFORMATION</a>	Re-loop/Exit loop, or adjust in & out point of manual loop

# Overview

#	PIONEER DJ DDJ-SX3 CONTROL	FUNCTION	SHIFT FUNCTION
18	PARAMETER	Adjust Parameter 1 in Performance pad modes	Adjust Parameter 2
19	PERFORMANCE PADS	SEE PERFORMANCE PADS FOR MORE INFORMATION	
20	CROSSFADER ASSIGN	Assign crossfader to channel A/THRU/B	
21	CHANNEL FADER	Adjust channel volume	Channel Fader start
22	CROSSFADER	Crossfade audio between channel A-B	
23	SAMPLER VOLUME	Adjust Sampler volume	
24	BOOTH MONITOR VOLUME	Adjust Booth output volume	
25	CHANNEL CUE	Press to cue channel for monitoring in headphones	
26	PLAY/PAUSE	Toggles Play/Pause on selected deck	Stutter play
27	CUE	Cues from temp cue point/Set temp cue point	Load previous track
28	SYNC	Turn Sync ON	Turn Sync OFF
29	QUANTIZE	Toggle Quantize ON/OFF	
30	SHIFT	Used with other controls that have SHIFT modifier function	
31	DECK SELECT	Change Deck layer. Press both simultaneously for dual deck select	
32	KEY SHIFT DOWN	Shift key down	Key sync
33	KEY SHIFT UP	Shift key down	Key reset
34	CENSOR	Censors playing track	Reverses playing track
35	NEEDLE SEARCH/TOUCH STRIP	Jump to track position	
36	JOG WHEEL	Control waveform within Serato DJ in vinyl mode, or pitch bend	Fast waveform scroll in vinyl mode or aggressive pitch bend
37	SLIP	Toggle Slip mode on selected deck	Toggle Vinyl mode

# Performance Pads

The Pioneer DJ DDJ-SX3 comes with 8 RGB performance pads, that can be used across 11 different performance pad modes.

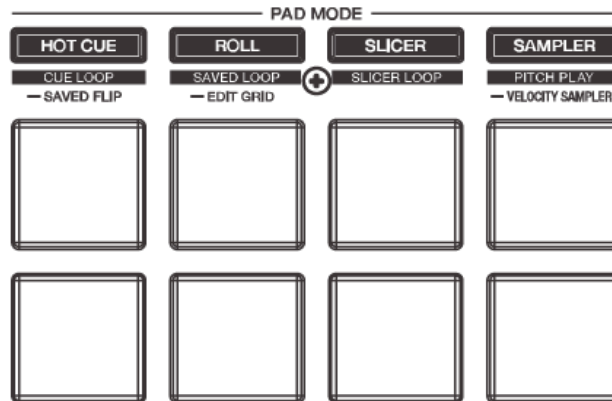

These consist of:

**HOT CUE mode:** Pads 1-8 trigger Serato DJ Pro Cue points, and if no Cue point is present on that slot/pad, pressing that pad will set a Cue point. Holding SHIFT while pressing a pad will clear the Cue point from that pad/slot.

**CUE LOOP mode:** Hold SHIFT while pressing the HOT CUE mode button to enter CUE LOOP mode. Pads 1-8 trigger Serato DJ Pro Cue points but also triggers an autoloop of variable sizes. If the selected slot has no Cue point present, one will be set. Holding SHIFT while pressing a pad will retrigger that Cue Loop. Use the Parameter left & right buttons to increase or decrease the loop size.

**SAVED FLIP mode:** Hold (or long press) the HOT CUE mode button for several seconds, to enter SAVED FLIP mode. In this mode pads 1-8 trigger Serato DJ Pro Cue points but also trigger an autoloop of variable sizes. If the selected slot has no Cue point present, one will be set. Holding SHIFT while pressing a pad will retrigger that Cue Loop. Use the Parameter left & right buttons to increase or decrease the loop size.

**ROLL mode:** In this mode holding pads 1-8 activates a loop roll of varying sizes. Release the pad to exit the Loop Roll. Use the 'Shift Autoloop range' controls in Serato DJ Pro to change the 8 selected loop size options.

**SAVED LOOP mode:** Hold (or long press) the ROLL mode button for several seconds to enter SAVED LOOP mode. In this mode, pressing pads 1-8 in this mode will trigger saved loops or save the current activate loop to the respective pad/slot. Holding SHIFT while pressing a pad will re-trigger (or reloop) the respective saved loop.

**BEATGRID EDIT mode:** Hold (or long press) the ROLL mode button for several seconds, to enter BEATGRID EDIT mode. In this mode, pads 2 & 3 make small grid adjustments left & right, while pads 1 & 4 make larger grid adjustments left & right. Pads 6 & 7 allow you to slip the beatgrid by small increments left & right, while pads 5 & 8 slip the beatgrid by larger increments, to the left & right. Use the Parameter left & right buttons to Set and Clear a beat marker. Increase the domain size. left & right buttons to decrease or increase the quantize size, or hold SHIFT while pressing them to decrease or increase the domain size.

# Performance Pads

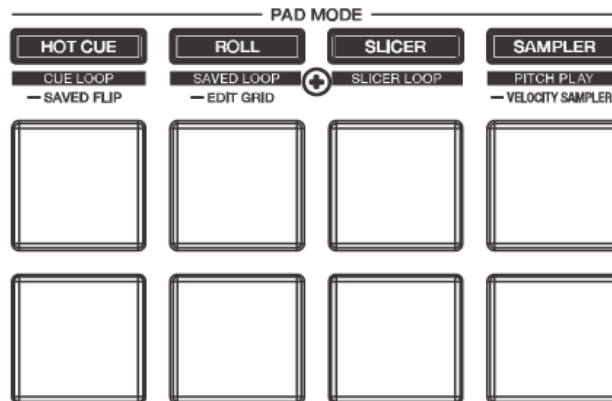

**SLICER mode:** In this mode a specified range (or domain) is divided into eight equal sections, and these eight sliced sections are assigned to the respective performance pads (1-8), and can be triggered by pressing them. The domain shifts as the track duration elapses. Use the Parameter left & right buttons to decrease or increase the quantize size, or hold SHIFT while pressing them to decrease or increase the domain size.

**SLICER LOOP mode:** Same as Slicer mode, but uses a fixed Slicer Domain or “loop”. Use the Parameter left & right buttons to decrease or increase the quantize size, or hold SHIFT while pressing them to decrease or increase the domain size.

**SAMPLER mode:** Press pads 1-8 to trigger samples loaded into the Serato DJ Pro Sampler. Hold SHIFT while pressing a pad to stop the sample playback once triggered, or load a sample to the respective Sampler slot if no sample is loaded. Use the Parameter left & right buttons to cycle through the Sample Banks, and hold SHIFT while pressing them to cycle through the Sampler Output options.

**PITCH PLAY mode:** Hold SHIFT while pressing the SAMPLER mode button to enter PITCH PLAY mode. PITCH PLAY mode requires the Serato Pitch ‘n Time DJ expansion pack activated, see the PITCH PLAY section for more information.

**SAMPLER VELOCITY mode:** Hold (or long press) the SAMPLER mode button for several seconds to enter SAMPLER VELOCITY mode. Controls are the same as Sampler mode above, but now triggered samples respect velocity to influence Sample volume.

# Pitch Play

Holding SHIFT and pressing the SAMPLER performance pad mode button on the Pioneer DJ DDJ-SX3 will enable Pitch Play mode. In this mode you can play Cue Points over variable pitch ranges.

There are 3 key ranges to choose from. The following tables show pitched key ranges (in Semitones) while using the 8 performance pads in Pitch Play mode. To toggle between key ranges press the Parameter left & right buttons.

The root key pad (0) is always lit white, which will play the cue point at its regular pitch.

Pressing Parameter left & right while holding SHIFT will shift up or down a single semitone. In Pitch Play mode, pressing a pad will pitch the currently selected cue point up or down the following ranges:

## Up Range: (Up 7 Semitones)

+4	+5	+6	+7
0	+1	+2	+3

## Middle Range: (Up 3/Down 4 Semitones)

0	+1	+2	+3
-4	-3	-2	-1

## Down Range: (Down 7 Semitones)

-3	-2	-1	0
-7	-6	-5	-4

When Pitch Play mode is first enabled, the middle range is selected. If a new track is loaded, key mode will default to middle range.

PITCH PLAY can only pitch one Cue point at a time. To change the selected Cue, hold the SHIFT button and press a performance pad where the cue point you want to select would be (as shown in the CUES performance pad mode). While holding SHIFT, press the corresponding performance pad for:

Cue 1	Cue 2	Cue 3	Cue 4
Cue 5	Cue 6	Cue 7	Cue 8

The selected cue point defaults to Cue Point 1 on track load, even if instant doubled. If a pad with no cue point is selected, then a new cue point will be created. Deleting a cue point however, is not possible in PITCH PLAY mode. Range is remembered if user goes to another pad mode, then back to key mode. If a new track is loaded, key mode will default to middle range.

**NOTE:** Pitch Play mode is available once the Pitch 'n Time DJ Expansion Pack has been activated in the MY SERATO window. Make sure "Enable Pitch 'n Time DJ" is checked in the Expansion Pack tab of the SETUP screen.

# DJ-FX

The DJ-FX in Serato DJ Pro are powered by iZotope™. Click the FX button  to open the FX panel. Select either 1, 2, 3, 4 or AUX to assign the selected effect bank to a deck or auxilliary output.

There are two available modes with DJ-FX. Single FX Mode allows you to select one effect per FX bank, and has multiple parameters that can be adjusted. Multi FX Mode allows you to select up to three effects per FX bank, and adjust only one parameter, the FX Depth. The same effects available in Single FX mode are available in Multi FX mode, as well some additional presets.

You can select between the two FX modes by clicking either the Single FX mode button  or Multi FX mode button .

DDJ-SX3 Control	Single FX mode	Multi FX mode	Shift function
FX Button 1	Effect On/Off	Slot 1 Effect On/Off	Slot 1 Select Effect
FX Button 2	Toggle FX parameter 2	Slot 2 Effect On/Off	Slot 2 Select Effect
FX Button 3	Toggle FX parameter 4	Slot 3 Effect On/Off	Slot 3 Select Effect
FX Level parameter	Adjust FX Depth (parameter 1)	Adjust FX Depth	Slot Select Effect

## Looping

You can control Auto and Manual Loops within Serato DJ Pro, using controls on the Pioneer DJ DDJ-SX3. **NOTE:** You can also save a loop to the next available free loop slot in the software. To do this, click  on an available loop slot. Your loops are saved to the file and recalled the next time it is loaded. They are not lost if the file is moved or renamed.

DDJ-SX3 Control	Function	Shift function
AUTO LOOP	Activate Autoloop	Loop Active
1/2X	Halve Loop Size	Shift Loop Left
2X	Double Loop Size	Shift Loop Right
IN	Set Loop IN point (Hold to create and activate a quick 4-beat Autoloop)/ Edit	Loop Slot Select Next
OUT	Set Loop OUT point/Edit	Reloop/Exit Loop

When in the Roll pad mode, you may also control Loop sizes with the 1/2x and 2x buttons.



# Flip

Flip is an Expansion Pack for Serato DJ Pro. Flip controls are only available once the Flip expansion pack has been purchased and activated. The expansion pack can be purchased in-app through the My Serato window in Serato DJ Pro or online at <https://serato.com/dj/pro/expansions/flip>

The DDJ-SX3 has dedicated Flip controls, for more information on using Flip, please check-out our [Flip User Guide](#).

If you already have a Serato Flip license, simply activate it by navigating to the 'Setup' screen in Serato DJ Pro, then to the 'Expansion Packs' tab, and then 'Flip', and finally, tick 'Enable Serato Flip'.

# Beat Jump

To activate Beat Jump, open the Setup screen and under the DJ preferences tab turn on "Show Beat Jump Controls".

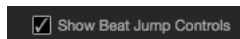

When you close the Setup screen you will see Beat Jump controls underneath the existing Auto Loop values on each deck. Checking this box will turn on Beat Jump features in the deck area and let you control Beat Jump from on your supported Serato DJ Pro hardware.



When the Beat Jump option is enabled, performance pad modes AUTO LOOP or ROLL mode will use the bottom row of 4 pads (pads 5-8) as Beat Jump controls. This is designed to mirror the change in deck Auto Loop area (from 8 Auto Loop sizes to 4 Auto Loop sizes + Beat Jump controls).

# DVS

The Pioneer DJ DDJ-SX3 is a "Paid upgrade to Serato DVS" device, meaning a separate Serato DVS license is required, in order to use turntables or CD players to control Serato DJ Pro using NoiseMap™ Control Tone records or CDs. These can be used in Channel 1 & 2 inputs on the DDJ-SX3.

Find out more about Serato DVS, [here](#).

If you already have a Serato DVS license, simply activate it by navigating to the 'Setup' screen in Serato DJ Pro, then to the 'Expansion Packs' tab, and then 'Vinyl / CDJ Control', and finally, tick 'Enable Vinyl / CDJ Control'.

# MIDI

The MIDI feature in Serato DJ Pro provides the ability to remap Serato DJ Pro software functions to your primary Serato controller, interface or mixer. You can also assign controls to a secondary MIDI controller to further enhance your performance.

[For more information on MIDI mapping with Serato DJ Pro click here](#)

To remap your supported Serato device, open the SETUP screen and click the MIDI tab. If your Serato device supports hardware remapping, it will show up in the MIDI Devices list at the top.

Select your connected device from the MIDI Devices list and make sure the “Allow Serato Hardware Remapping” option is checked.

Allow Serato Hardware Remapping

Once checked, the MIDI assign button at the top of the screen will become available for you to start remapping.

You can save, edit or delete MIDI presets in the MIDI tab of the SETUP screen. Clicking ‘Restore Defaults’ will erase any custom mappings for all connected devices and revert their functions back to default.

# Help

## Show Tooltips

Click on the **Help** button in the upper right-hand corner of Serato DJ Pro, then **Show tooltips** to enable tooltips. Tool tips provide a handy way to learn the various features of Serato DJ Pro.

Move the mouse over a section of the screen to bring up a context sensitive tool tip.

## Watch Tutorials

Click on the **Help** button in the upper right-hand corner of Serato DJ Pro, then **Watch tutorials** to launch your default internet browser and watch tutorials, to help you get familiar with Serato DJ Pro.

## Get Support

Click on the **Help** button in the upper right-hand corner of Serato DJ Pro, then **Get support** to launch your default internet browser and navigate to the Serato DJ Pro knowledge base, where you can find helpful articles and guides on Serato DJ Pro. Alternatively, type in the **Search help** **Go** box, with keywords, to search the Serato DJ Pro knowledge base for specific, related topics.